



v.2 Installation Manual 3.1

TOOL REQUIREMENTS

Basic SAE or Metric Socket Set

Flathead Screwdriver

Wire Brush

5/16" or 11mm Open end Wrench

1/8" Allen Key

Red Loctite

Wire Cutters

Drill and 5/16" drill bit



ID	DESCRIPTION	QTY
(A)	CDT Module	1
(B)	CDT Deutsch Plug	1
(C)	GPS Device	1
(D)	Tamper Sensor	1
(E)	Primary Harness	1
(F)	Stainless Ground Hardware	1
(G)	140 dB Siren	1
(H)	Bag 10-Zip Ties	1
(I)	3M VHB Double Sided Tape	2
(J)	Reflective Warning Decals	2
(K)	STOP Battery Warning Decal	1

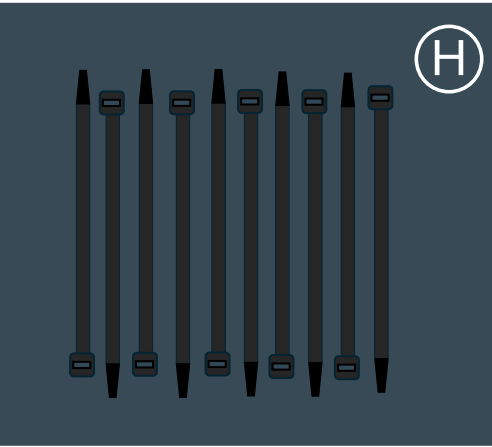
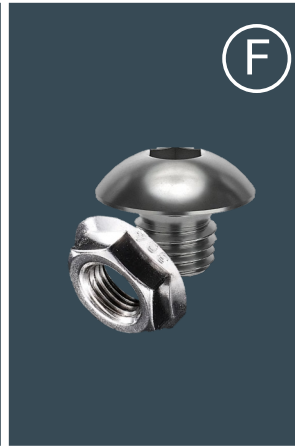
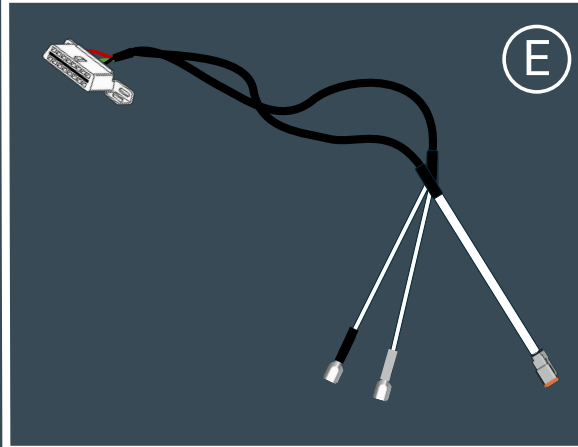
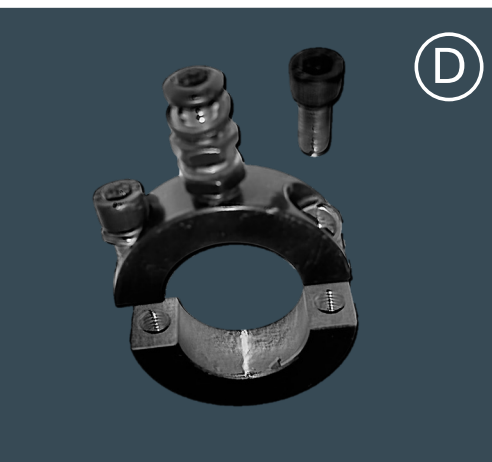
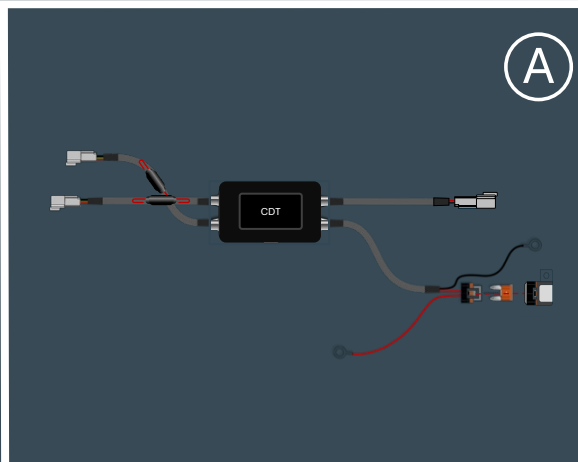

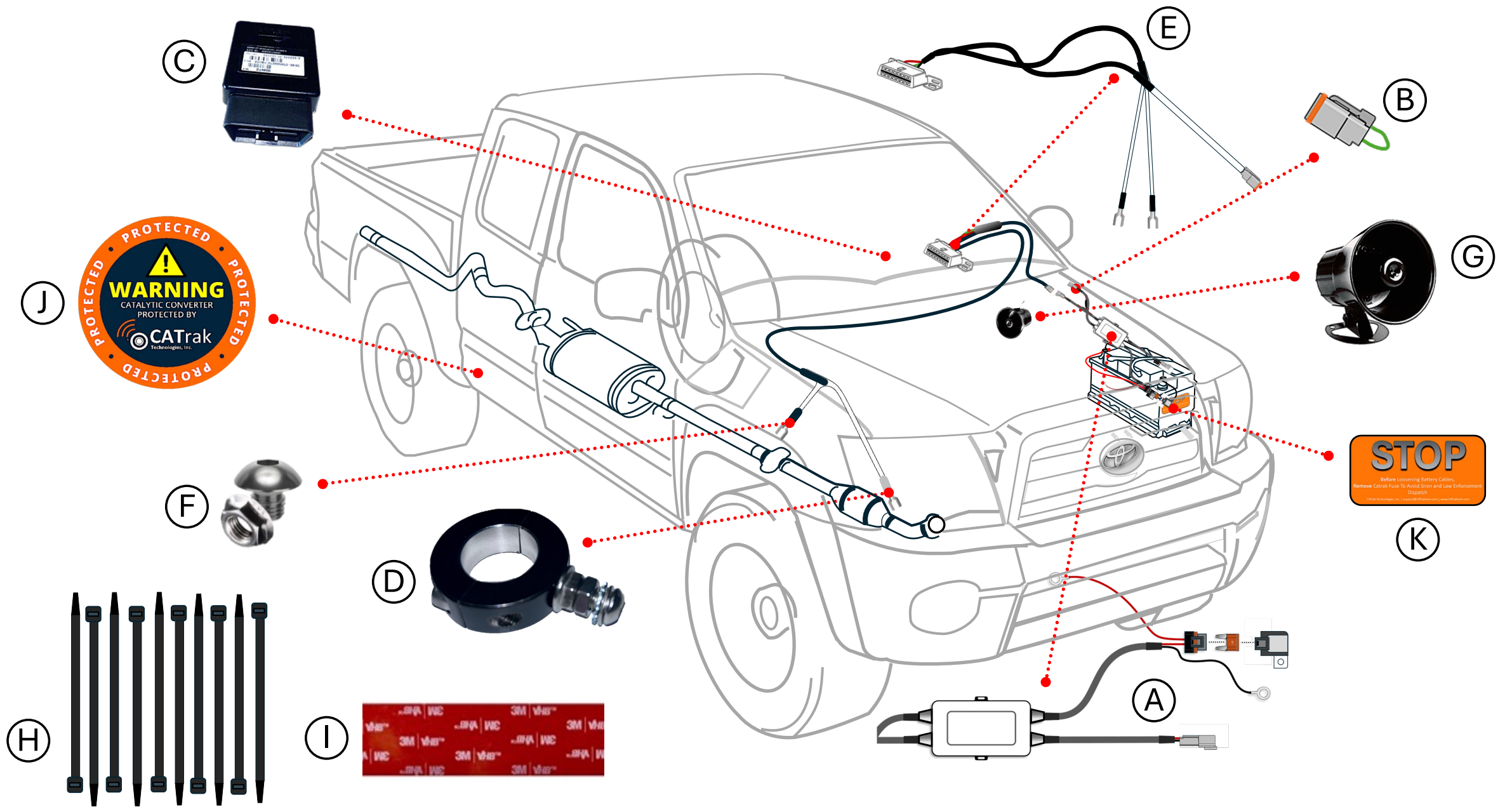

COMPONENT PLACEMENT OVERVIEW



DOWNLOAD THE CATRAK APP.



User Credentials required to use the App, upon receipt of credentials, please download the CATrak App. Follow the installation instructions as defined in this manual. Upon completion of the post-hardware installation and circuit test, the CATrak App will reflect, **“INSTALLATION COMPLETED.”**

If you are unable to access the info., please verify credentials by contacting the vehicle/fleet owner if login issues persist.



To avoid high temperature and moving parts, review the vehicle layout and have a harness routing and management plan prior to starting the installation.

2

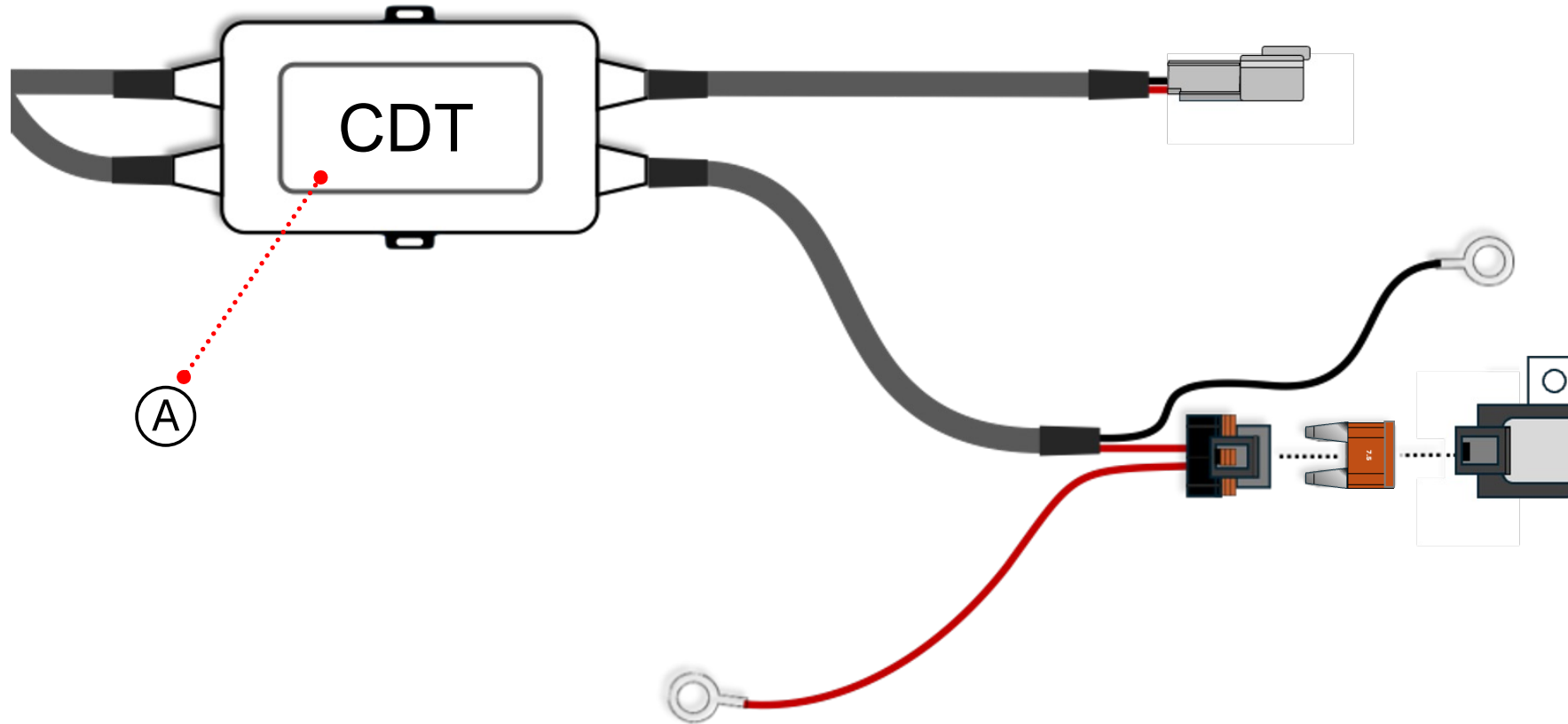

REMOVE 7.5 AMP FUSE FROM CDT PRIOR TO INSTALLATION

CDT has zip tie loops molded into each side. We strongly recommended that the CDT is mounted to an existing OEM wiring harness using one or more of the zip ties provided.

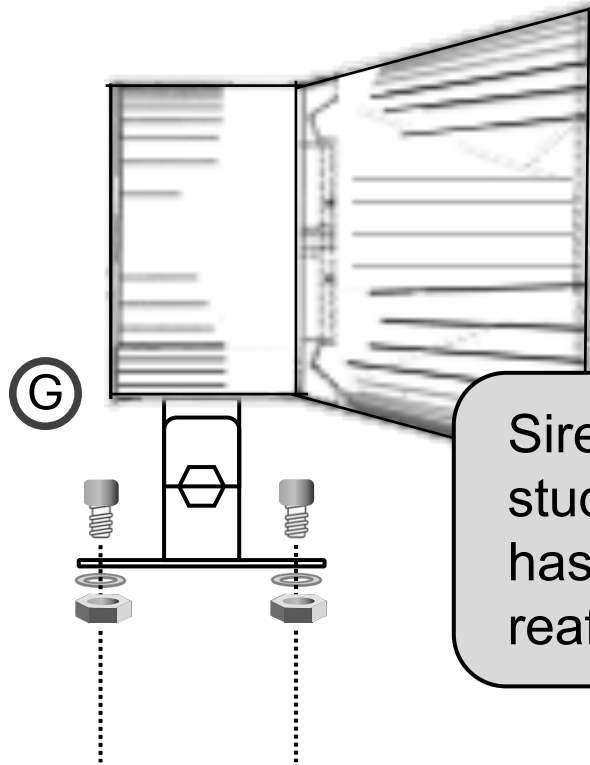
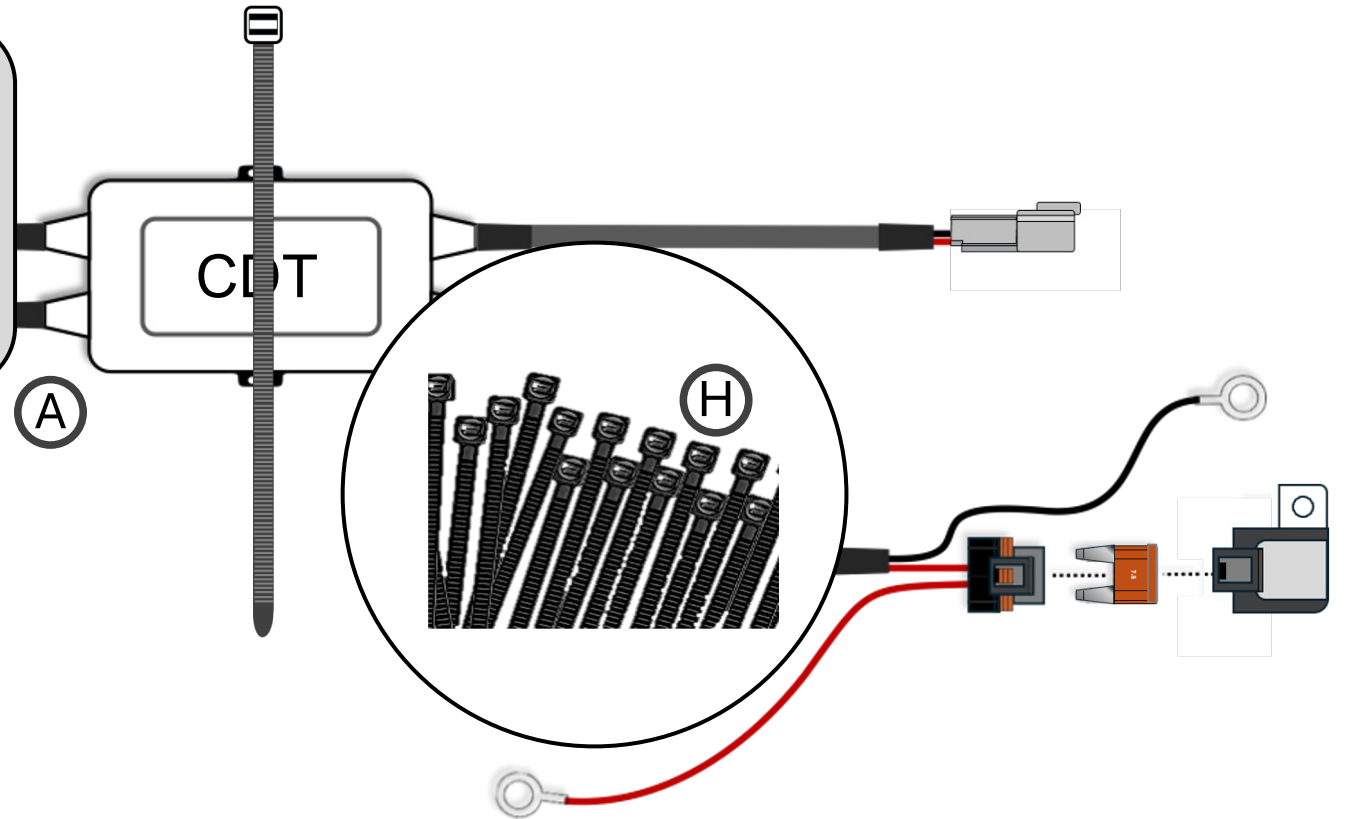

Siren should be affixed to an existing stud or bracket in the engine bay that has a nut, or by removing and reaffixing an existing bolt.

HARDWARE MOUNTING BEST PRACTICES

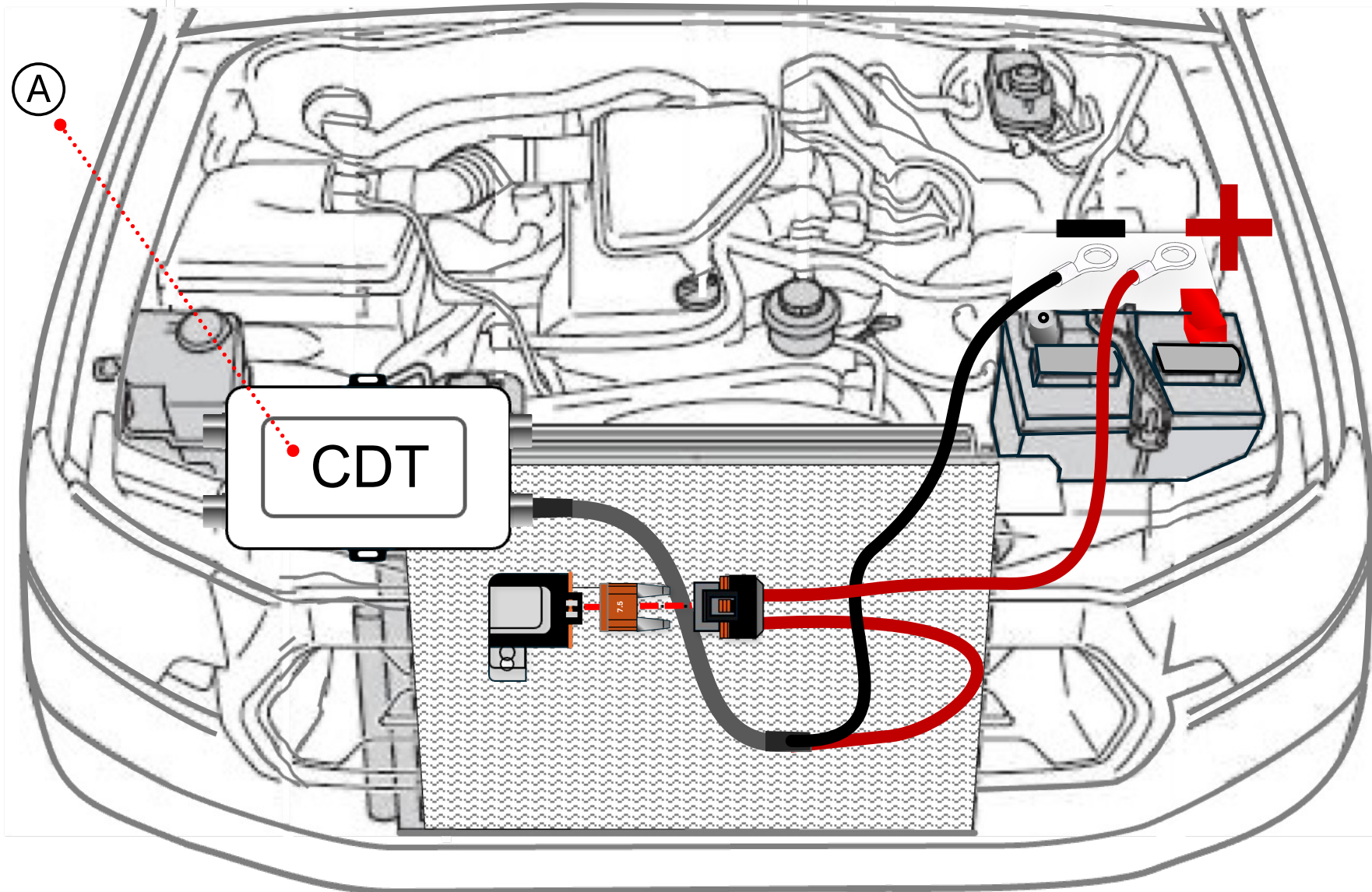

3



Inspect battery terminals for corrosion, clean terminals prior to installing ring terminals if needed.

CONNECT CDT POWER AND GROUND TO VEHICLE BATTERY

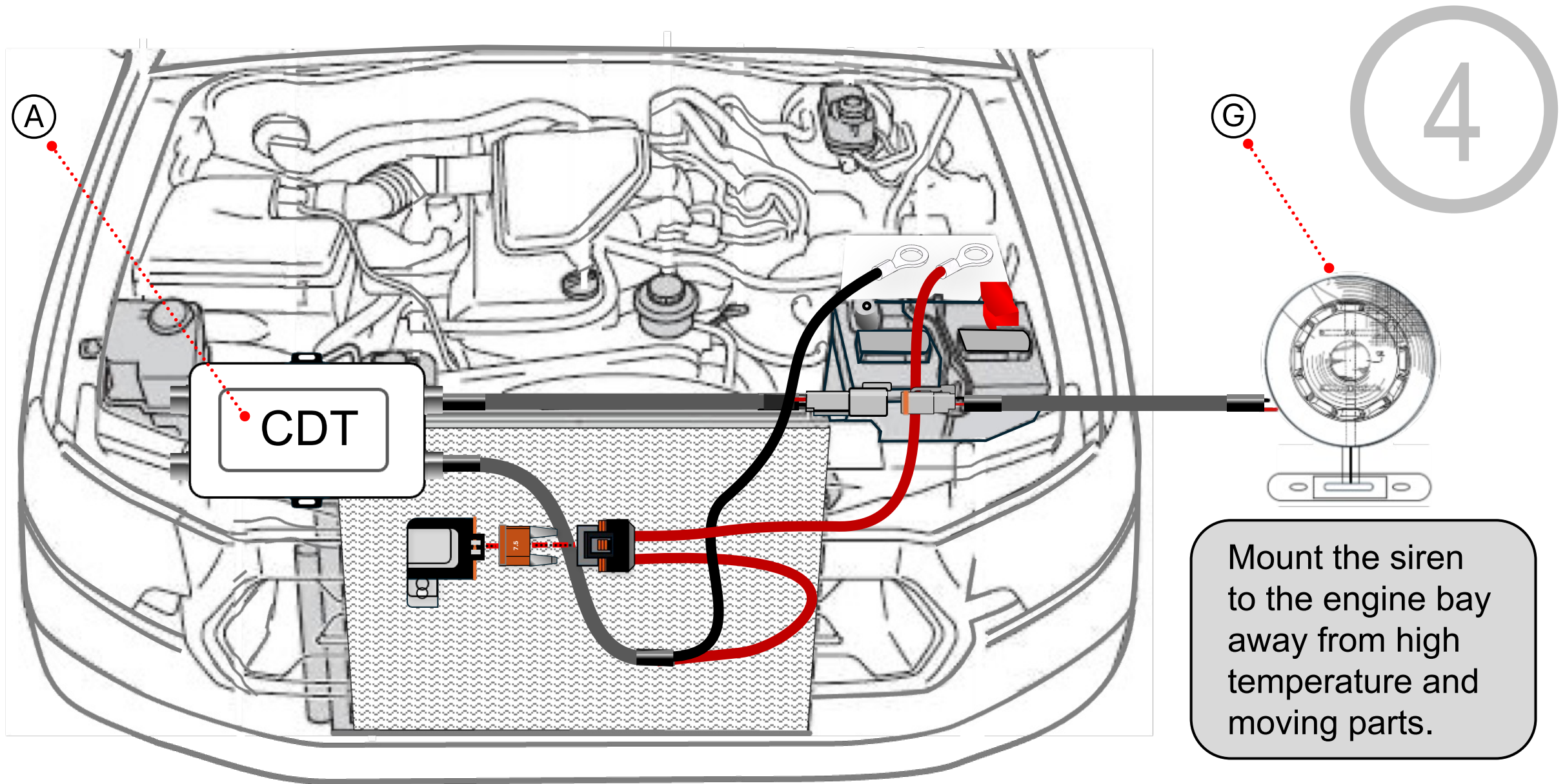

MOUNT SIREN AND CONNECT TO CDT

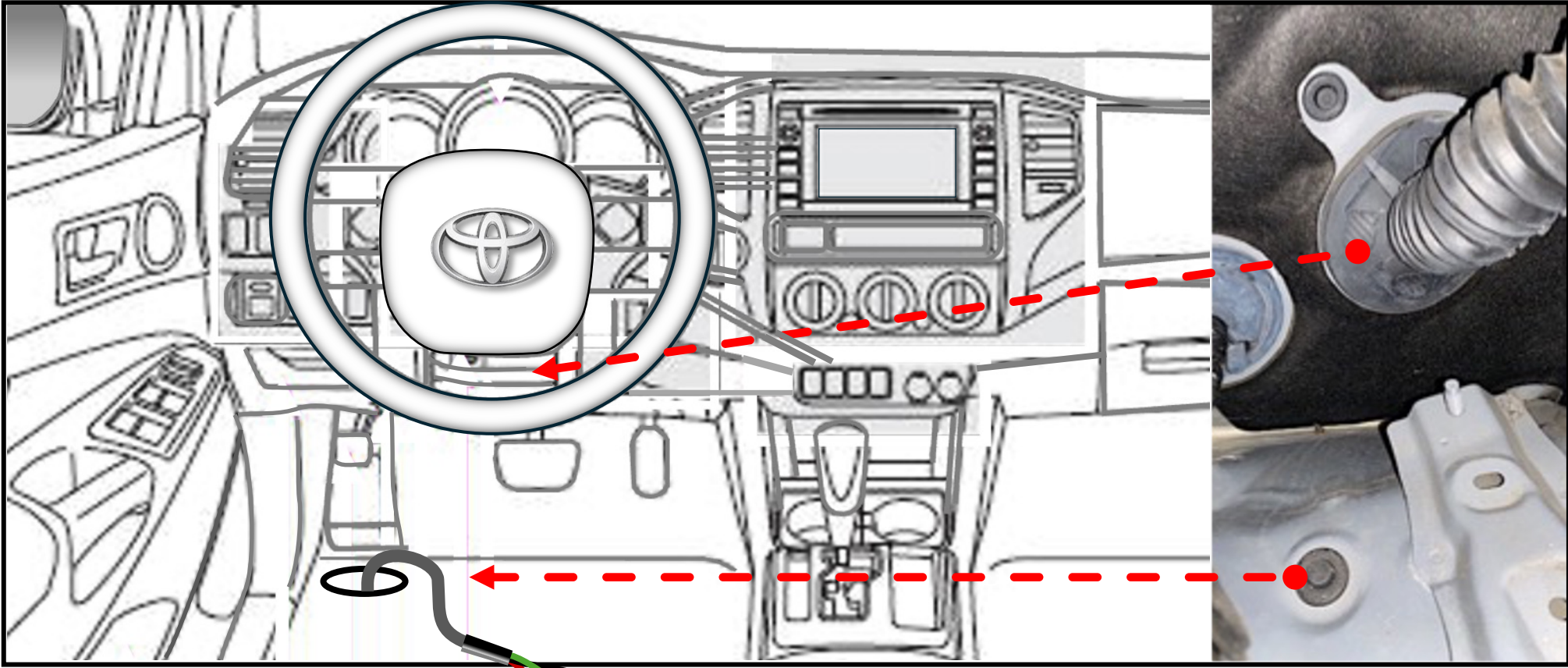



ⓔ

ROUTE PRIMARY HARNESS THROUGH FLOOR OR STEERING

Depending on the size of the floor grommet, it may be best to feed the primary harness from inside of the cab downward toward the catalytic converter.

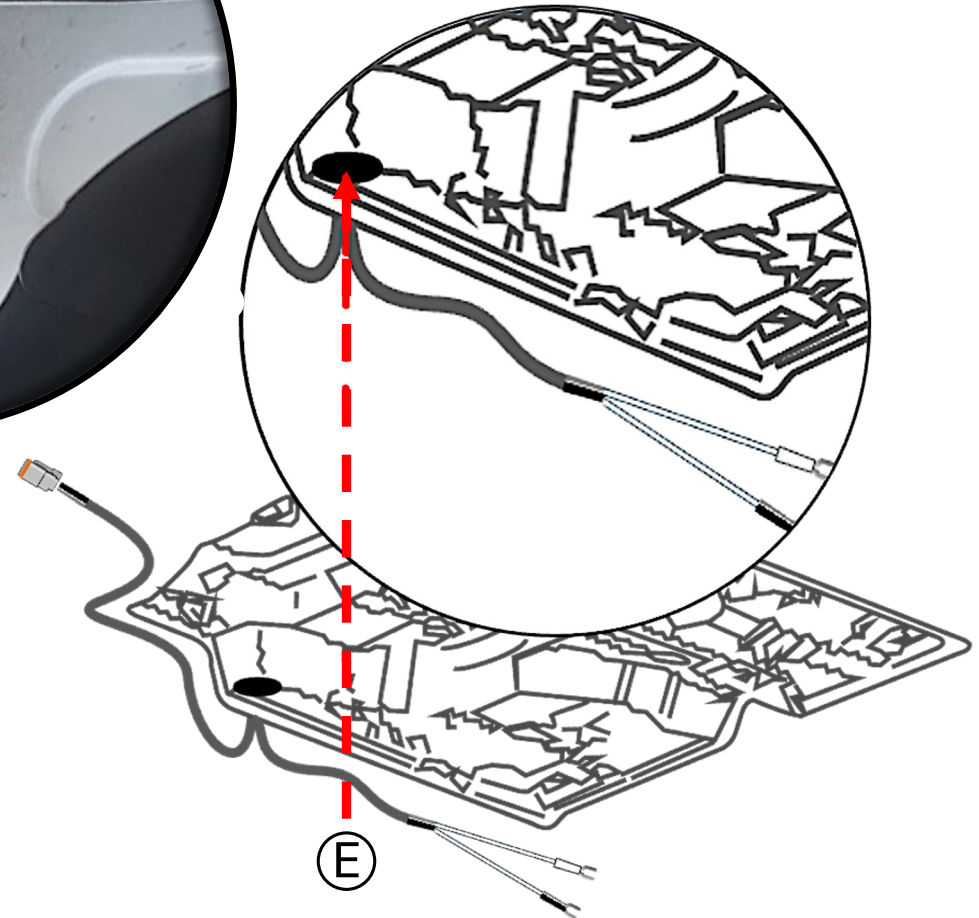
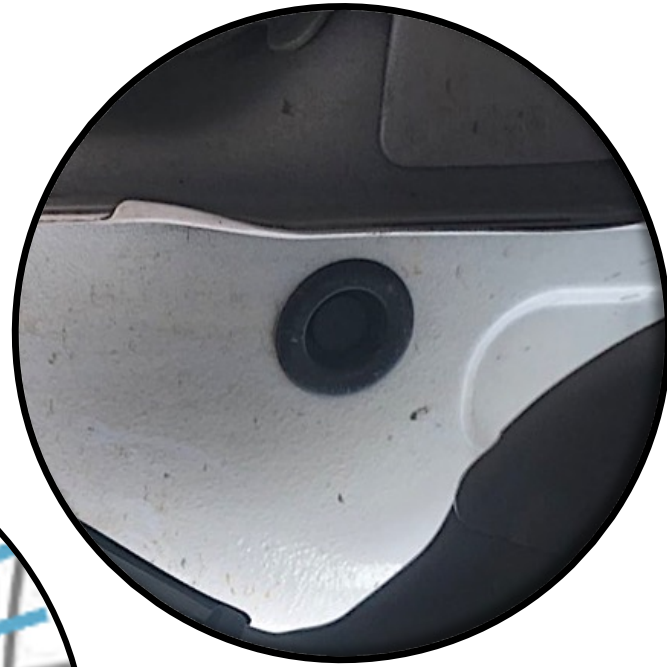
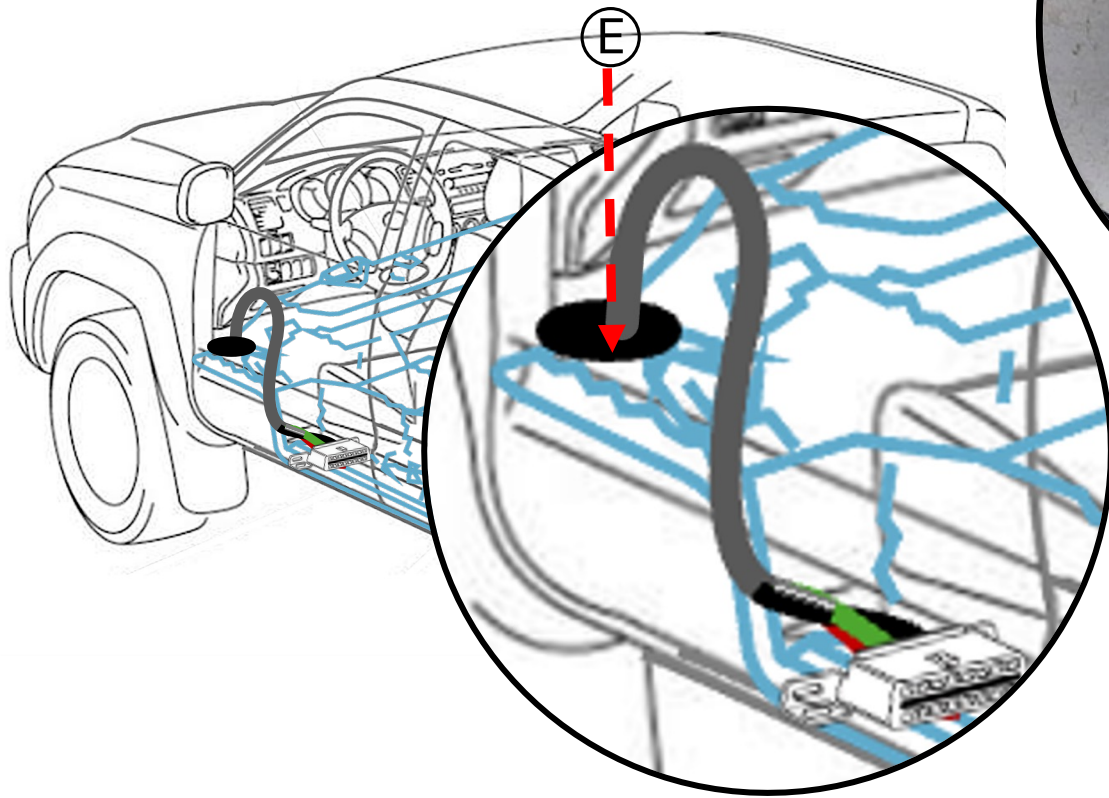

PRIMARY HARNESS ROUTING EXAMPLE

6



Tamper sensor fits **AROUND** base of oxygen sensor.

OEM OXYGEN SENSOR HARNESS

DO NOT REMOVE OXYGEN SENSOR OR FACTORY O2 SENSOR HARNESS!

BLACK CONNECTOR

PRIMARY HARNESS

E

CLEAR CONNECTOR

F



Creating a quality chassis ground is extremely important. There are two connections that are required on the exhaust/catalytic converter. The black fork connector is applied toward the rear of the exhaust with the clear fork connection attached to the tamper sensor. If there is no heat shield, use the exhaust flange studs or posts.

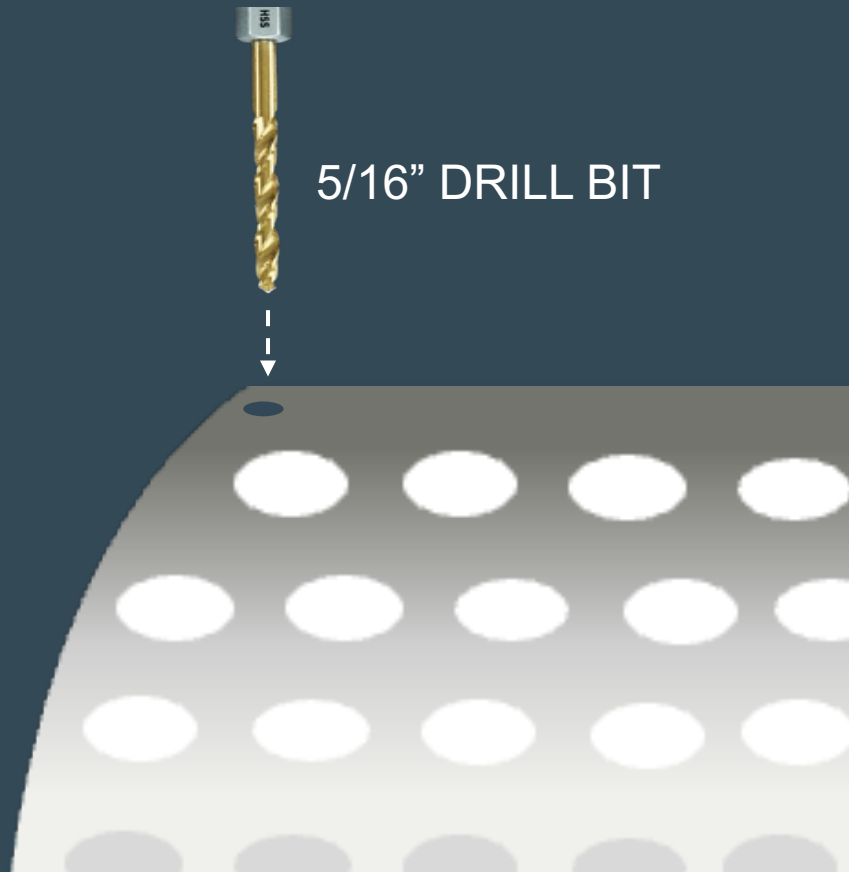

CAREFULLY drill into exhaust heat shield to mount ring terminal for chassis ground.

DO NOT DRILL HOLE INTO CATALYTIC CONVERTER!

7

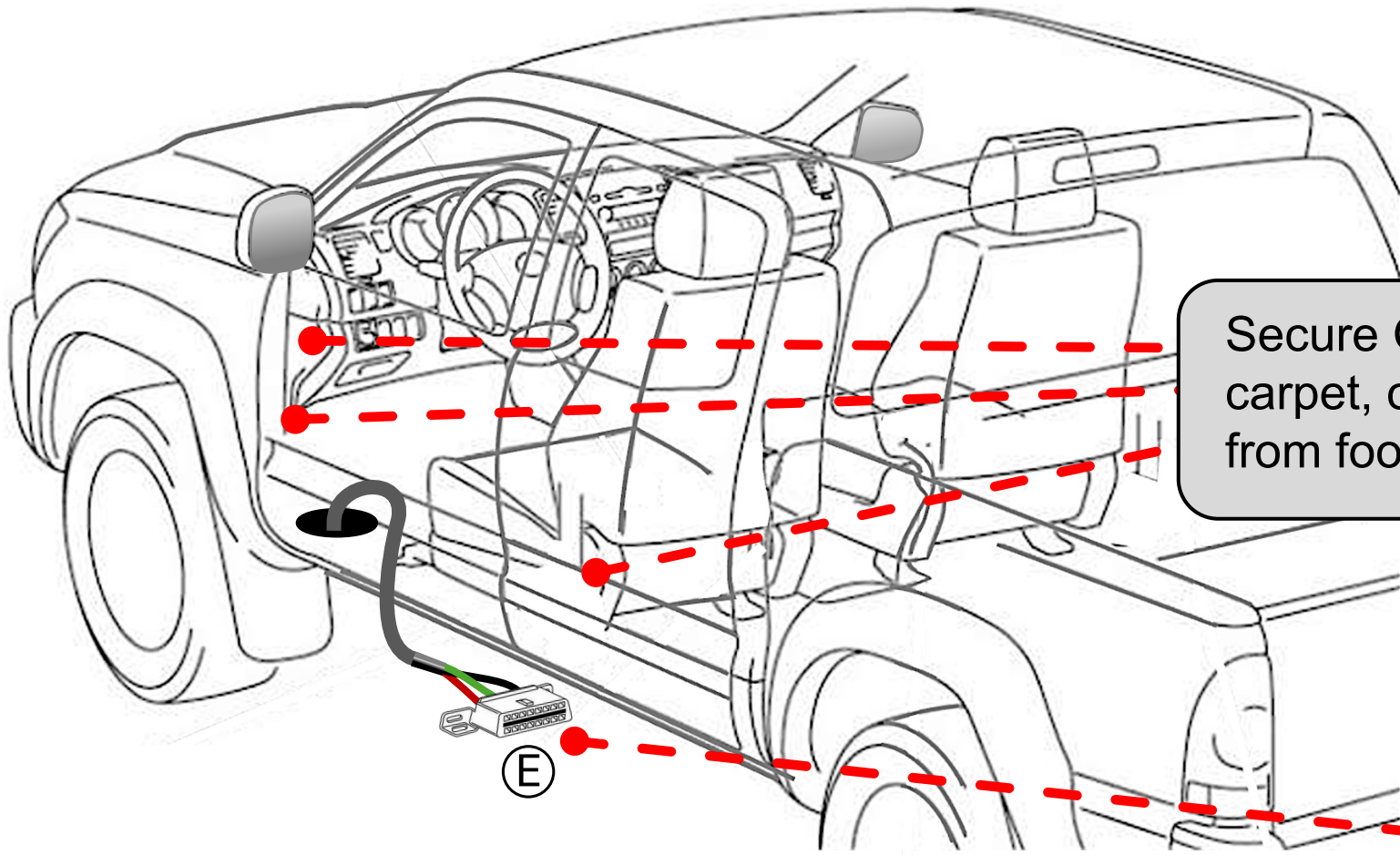

Secure GPS device in dash, under carpet, or behind the kick panel away from foot traffic and potential liquids



CONNECT GPS DEVICE TO PRIMARY HARNESS

With all hardware properly installed, the siren **WILL NOT** make a sound when installing the 7.5 AMP fuse. If the siren **does make a sound**, double check all connections and repeat the process.

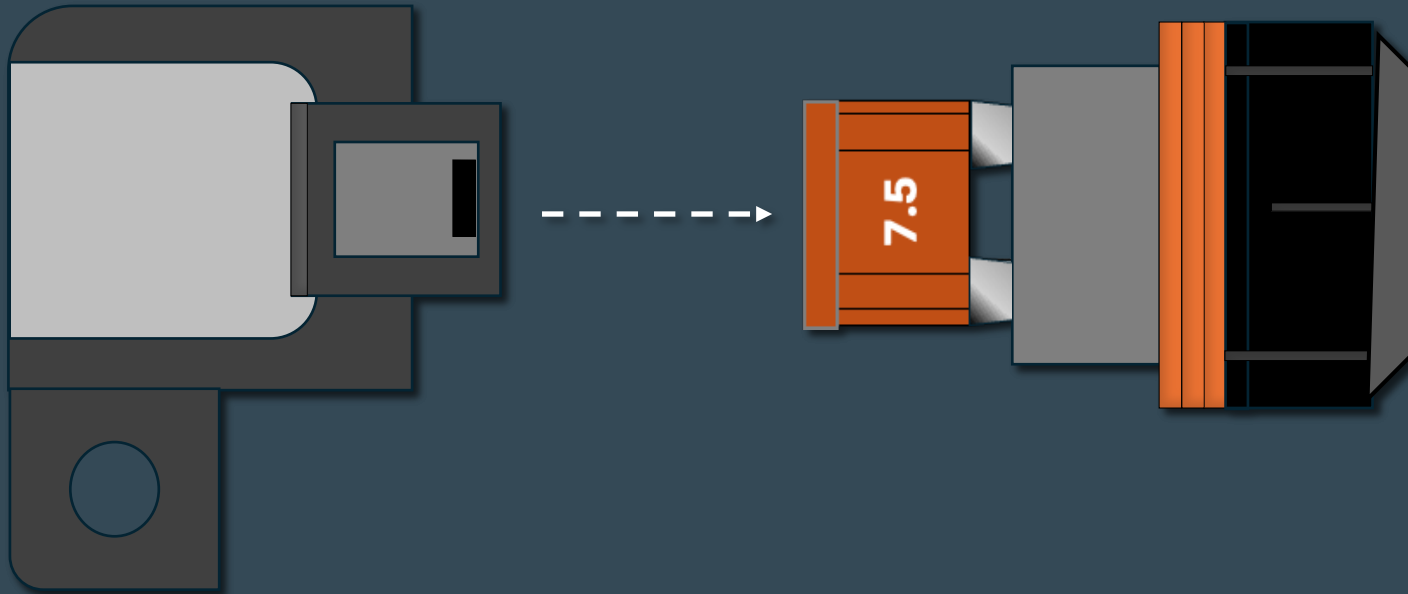

REINSTALL 7.5 AMP FUSE

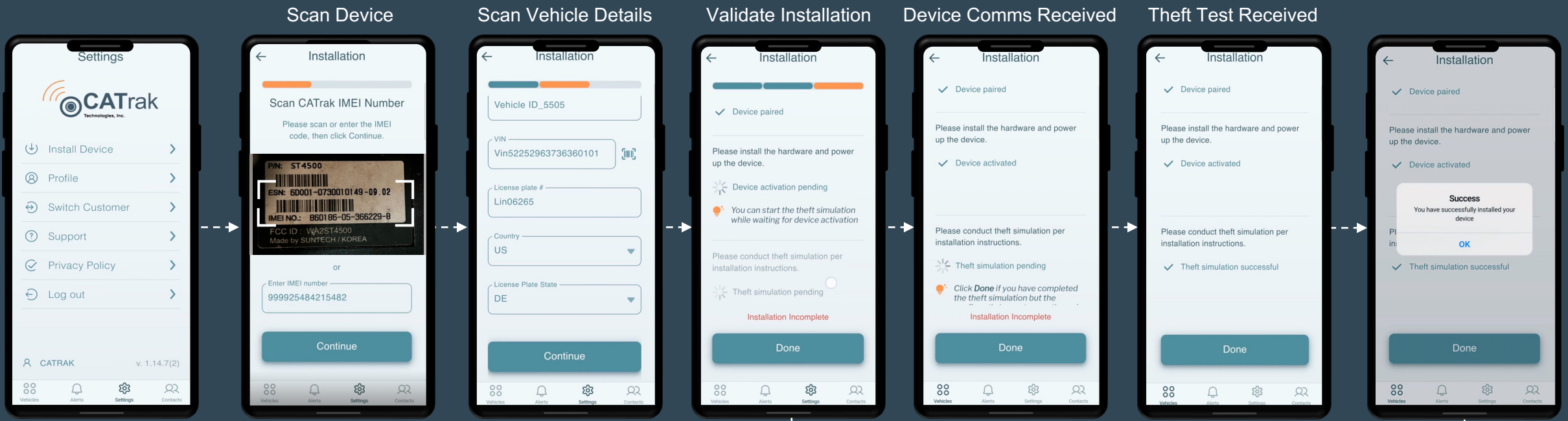

THEFT SIMULATION

SUCCESSFUL TEST

IF NO CELLULAR SIGNAL AVAILABLE

INSTALLATION COMPLETE

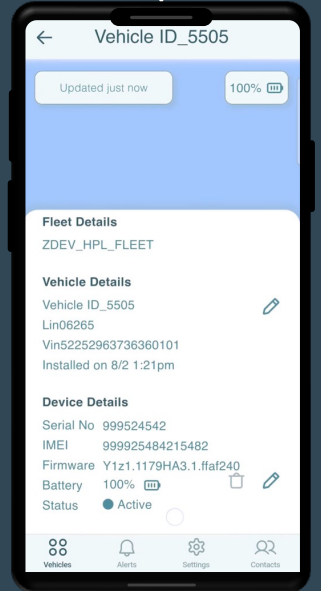
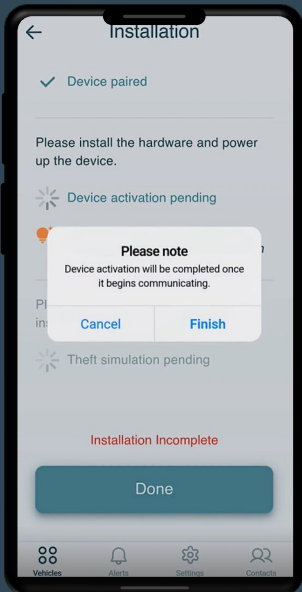
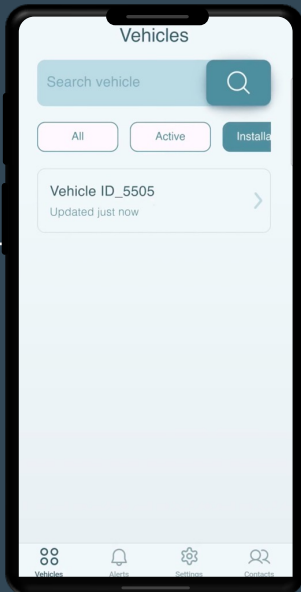

Pending installations appear in vehicles list and can be opened again from here.

System will activate device when it is in cell range and comms begin

1. Remove PRIMARY HARNESS (E) from CDT (A)
2. Siren (G) activates concurrent with SMS text, "THEFT IN PROGRESS"
3. The siren sounds for 60 seconds; unplug siren to silence (if you choose)
4. Reconnect PRIMARY HARNESS

THEFT SIMULATION

1 PRIMARY HARNESS CONNECTION

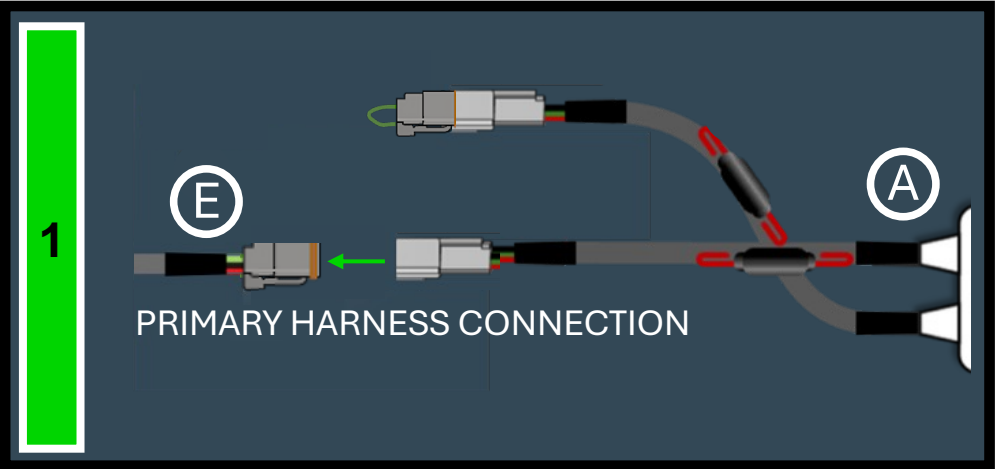

2



3 PRIMARY HARNESS CONNECTION

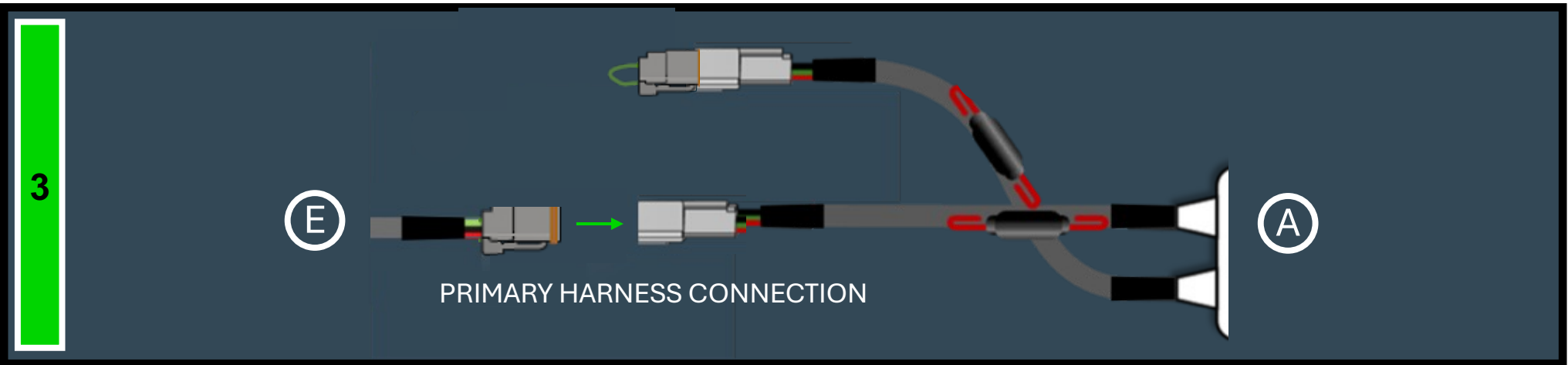

INSTALLATION COMPLETE

1. Can I install the GPS device under the hood to make the installation quicker and easier? **No, it is not recommended and will void the mfg. warranty**
2. Is the black wire cover rated for the same temperature as the white wire cover? **No, White has a much higher rating at 1800°F**
3. What happens if I mix up the CDT Deutsch Plug and the secondary harness connections? **Nothing, the circuits are universal**
4. Can I power the CDT at any power source, or does it have to be connected to the battery? **It must be connected to the battery for mfg. warranty**
5. Is the CDT rated for relevant temperatures in an engine compartment? **The CDT housing is rated above 200°F indirect heat, common sense applies**
6. Is the entire CATrak circuit IP67 rated? **Yes, although some GPS devices may not be (see device mfg. warranty)**
7. Why would the siren activate when I plug the fuse in? **This indicates a weak ground at the exhaust, make sure and clean surface with a wire brush**
8. I'm able to plug the fuse in but the siren chirps, is this acceptable? **No, same applies to #7**
9. What do I do if the siren activates randomly, but not all the time? **Repeat #7, then double check all connections, be sure to clean with wire brush**
10. Where do I mount the CDT if there are no harnesses to zip tie it to? **Use the VHB double sided tape provided. Clean, flat surface on a non serviceable part is a good default. Make sure and prep the area with a nonoil base cleaner and rag and apply the VHB evenly**
11. Where do I mount the siren? **For best results, find a stud or bolt at the engine bay near the battery and secure**
12. Can I use VHB to mount the siren? **It is not recommended, the siren should be secured with a bolt and facing downward to avoid water ingress**
13. Where do I mount the chassis ground hardware if there's no heat shield over the catalytic converter? **An exhaust flange is recommended**
14. Does CATrak Technologies have a 1-800 number to call for installation support? **CATrak is equipped with a Tier-1 support, defer to website**
15. Will the siren activate without cellular coverage? **No, the siren does not require cellular. The siren is the 2nd. Line of defense, 1st. Being the decal**
16. What happens if I am unable to get a cellular signal when installing, can I finish without testing? **A circuit test upon completion is mandatory**

FREQUENTLY ASKED QUESTIONS